

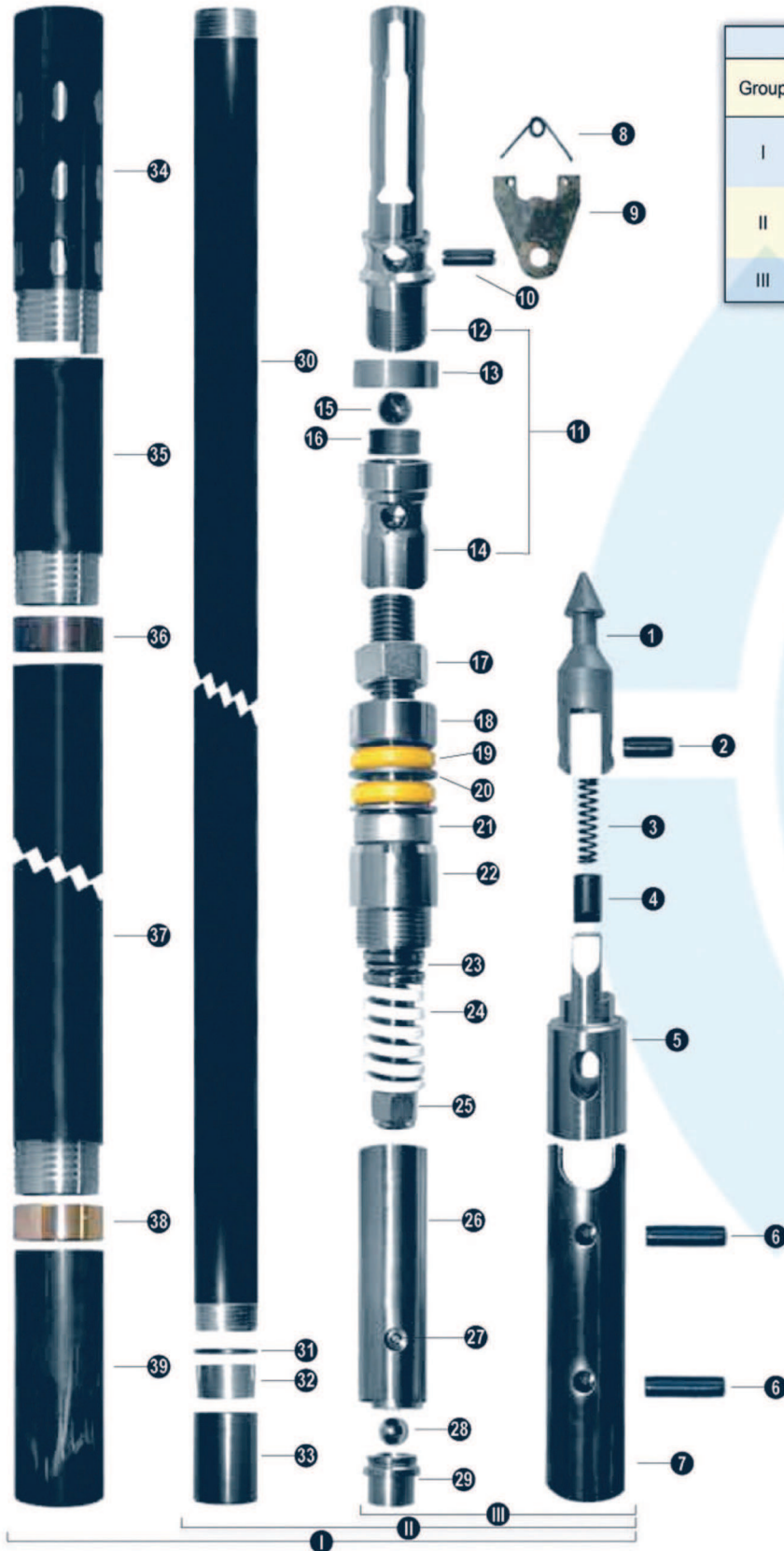

WIRELINE CORE BARREL

"Knuckle Head" Size : B



ASSEMBLIES				
Group	Description	Part No	Weight	
			lb	kg
I	Core Barrel Assy FF			
	5'	WB0205	54.00	24.5
	10'	WB0210	90.00	40.8
II	Inner Tube Assy FF			
	5'	WB1205	21.00	9.5
	10'	WB1210	28.00	12.7
III	Head Assy FF	WB2002	11.50	5.2

1	Spearhead point	WBNH2201
2	Spiral pin (7/16" X 1")	WBNH2205
3	Compression spring	WBNH2202
4	Detent plunger	WBNH2203
5	Spearhead base	WB2204
6	Spring pin (2) (3/8" x 1 5/8")	WB2103
7	Latch retracting case	WB2206
8	Latch spring	WB2104
9	Latch (2)	WB2105
10	Spiral pin (3/8" x 1 1/4")	WB2106
11	Latch body assy	WB2909
12	Upper body	WB2909-1
13	Landing shoulder	WB2909-2
14	Lower body	WB2909-3
15	Steel ball 22 mm	WBNH2909-4
16	Landing indicator bushing	WBNH2909-5
17	Lock nut	WB2110
18	Spindel assy	WB2111
19	Shut-off valve (2)	WB2112U
20	Valve adjusting washer (2)	WB2113
21	Ball thrust bearing	WB2114
22	Spindle bearing	WB2115
23	Ball thrust bearing	WB2114
24	Compression spring	WB2116
25	Self lock nut	WB2117
26	Inner tube cap assy FF	WB2119
27	Grease fitting	WB2120
28	Steel ball (3/4")	WB2121
29	Check valve body	WB2123
30	Inner tube 5'	ITB2125
30	Inner tube 10'	ITB2130
31	Stop ring	WB2132
32	Core lifter	WB2133
33	Core lifter case	WB2131
34	Locking coupling standard	WB2134
35	Adaptor coupling	WB2135
36	Landing ring	WB2136
37	Outer tube 5'	OTB2145
37	Outer tube 10'	OTB2150
38	Inner tube stabilizer	WB2139
39	Thread protector	WB2140